



Peace & Comfort

WALNUT CREEK

4949 Walnut Street, SR515
Walnut Creek, Ohio 44687
Phone 330 893 3636
1-855-400-2275

www.dhgroup.com

INN HOURS

Open all year

Noon Closing - Christmas Eve Day
Closed Christmas Day

Our mailing address is:

Carlisle Inn

P.O. Box 177

Walnut Creek, Ohio 44687

Carlisle Inn Accommodations

At the Carlisle Inn, the combination of scenic country town and big-city amenities allows guests to relax and take it easy in comfort and peace. Its 52 beautifully decorated guest rooms also afford them a surprising range of room options. Almost every room features a balcony or porch with outdoor seating from which to view the beautiful countryside.

Standard rooms are generously proportioned and feature beautiful beds—either one queen, one king, or two queens, and separate dressing areas. With the exceptions of 5 rooms, all other rooms have walk-in showers, and both honeymoon suites have a walk-in shower and 2-person Jacuzzis. The two-bedroom suite includes the convenience of a cozy living area between the sleeping quarters for sharing quality time. Our barrier-free room, complete with roll-in shower, offers complete accessibility, as do all hotel common areas.

Common areas and public spaces are designed to extend the graciousness and warmth of the guest rooms. Groups especially enjoy the inviting sitting areas scattered throughout the hotel, furnished with overstuffed sofas and comfy chairs. Perfect for quiet conversations, games, reading, and relaxing, these special spots include a sunny second-story breakfast room where our complimentary breakfast is served each morning.

Hotel at a Glance

Directions and Map

Room Descriptions

Group Rates

Reservation Guidelines



Hotel at a glance...

Carlisle Inn Walnut Creek offers...

- 28 standard rooms with two queen beds
- 5 standard rooms with one king bed
- 8 smaller standard rooms with one queen bed
- 6 executive rooms with one king bed
- 2 two-bedroom suites with two queen beds
- 2 honeymoon suites with one king bed
- 1 handicapped accessible with one queen bed and one twin bed
- Balconies or Porch access for 50 rooms
- Beautiful views of surrounding countryside
- 24-hour accessible fitness room
- No-step entrances
- Interstate access 14 miles from our location
- Bus parking available
- Wireless Internet access in every room.
- *USA Today* available 24 hours a day
- A piano, puzzles, games
- Coffee and tea available 24 hours a day
- Complimentary evening snack

Note: Carlisle Inn is a smoke-free facility. Alcoholic beverages are not served or permitted in our meeting rooms and public areas. Sorry, we do not allow pets in our hotels.

Breakfast –

We serve a complimentary deluxe continental breakfast every morning.

Breakfast may include

Der Dutchman Homemade Cinnamon Rolls and Homemade Breads
 Donuts
 Bagels
 Hard-Boiled eggs
 Variety of cold cereals & instant oatmeal
 Coffee, hot chocolate, tea
 Waffles
 Apple, grape, and orange juices
 Yogurt
 Mixed fruit and fresh fruit
 Pastries
 Muffins
 Scrambled eggs or Sausage gravy biscuits
 Sausage Patties

Banquets and Meeting Rooms –

With plenty of parking and no-step entrances for easy access, Carlisle Inn accommodates up to 450 people in banquet-style seating with straight tables.

The banquet room can be divided into two or three separate meeting spaces, each supplied with its own audio visual and sound equipment.

Our third floor board room accommodates up to 60 people in theater style seating. We do not offer dining in our room.

Detailed information sheets on meeting rooms and banquet services are available.

Things to do –

Shops, restaurants, and attractions abound in Amish Country, but Walnut Creek stands out as a group destination. In its stores and businesses, you can browse for treasure and learn about the area's heritage while also enjoying opportunities to interact with the people who work and live in this community. Within steps of the Carlisle Inn and Der Dutchman Restaurant, are two establishments that provide a delightful diversion.

Der Dutchman Bakery

330 893 2981

In this cozy bake shop, display cases and shelves are constantly replenished with fresh-from-the-oven treats; cinnamon rolls, loaves of breads, buttermilk cookies swirled with caramel icing, fresh apple fritters, cream-filled coffeecakes and an astounding variety of homemade pies, from classic Dutch apple to the distinctly Amish Peanut Butter Cream. There's even a choice of sugar-free pies and cakes.

Carlisle Gifts

330 893 2535

This stately Victorian holds three floors of precious gifts, charming keepsakes, beautiful jewelry, and home accents—plus the delightful experience of being able to leisurely consider fine things in a small town setting.

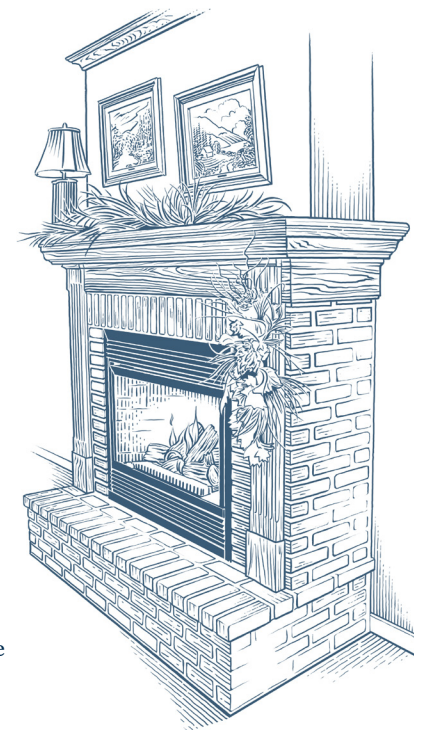

The restaurant, bakery, and gift shop are closed on Sundays and Mondays.



Peace & Comfort

WALNUT CREEK

4949 Walnut Street, SR515
Walnut Creek, Ohio 44687
Phone 330 893 3636
1-855-400-2275

www.dhgroup.com

INN HOURS

Open all year

Noon Closing - Christmas Eve Day
Closed Christmas Day

Our mailing address is:

Carlisle Inn

P.O. Box 177

Walnut Creek, Ohio 44687

Directions

From I-77 (Cleveland, Akron/Canton, Cambridge)

From I-77, take the Dover/Sugarcreek exit #83 and follow Route 39 West for approximately 14 miles. You'll pass through the village of Sugarcreek and continue on to Walnut Creek. At the intersection of Route 39 and State Route 515, turn right onto Route 515. You'll find the Der Dutchman Restaurant, Carlisle Inn, and Carlisle Gifts all located along 515 (Walnut Street) in the center of town.

From the south (Columbus...)

Take Route 62 or 83 from the south to Millersburg. In Millersburg, turn right onto Route 39, continuously east through the town of Berlin on to Walnut Creek, approximately 11 miles. At the traffic light at the intersection with State Route 515, turn left onto Route 515. You'll find the Der Dutchman Restaurant, Carlisle Inn, and Carlisle Gifts all located along 515 (Walnut Street) in the center of town.

From the Northwest (Mansfield, Wooster)

The easiest route is to take 83 south to Millersburg. Turn left onto Route 39, traveling east to Walnut Creek. At the traffic light at the intersection with State Route 515, turn left onto Route 515. You'll find the Der Dutchman Restaurant, Carlisle Inn, and Carlisle Gifts all located along 515 (Walnut Street) in the center of town.

For a more scenic route, traveling either Route 30 or Route 250, take Kidron Road (County Road 52) south to Route 241. Turn right onto Route 241 and follow its bends through northern Holmes County to Mt. Hope. At the stop sign (the major intersection of Mt. Hope) continue straight on County Road 77. Follow 77, passing through the intersection with Route 62 at the hilltop in Bunker Hill. Turn left onto the next major thoroughfare, Route 39, traveling east to Walnut Creek. At the traffic light at the intersection with State Route 515, turn left onto Route 515. You'll find the Der Dutchman Restaurant, Carlisle Inn, and Carlisle Gifts all located along 515 center of town.

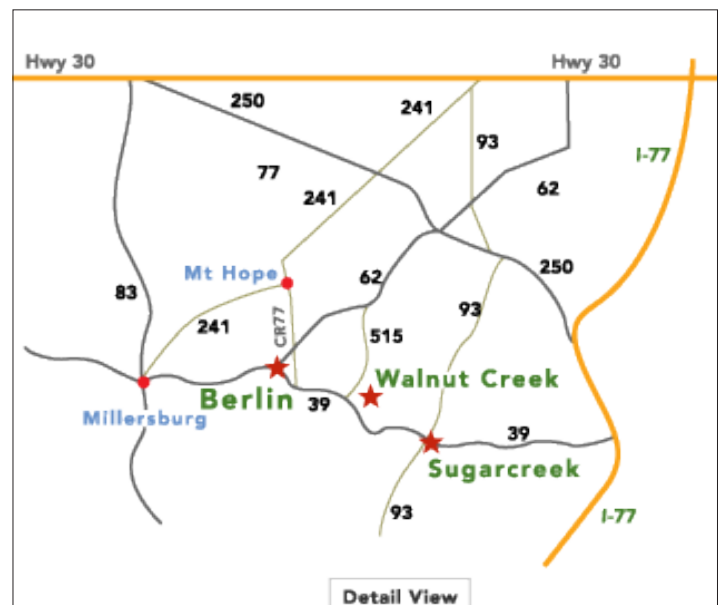
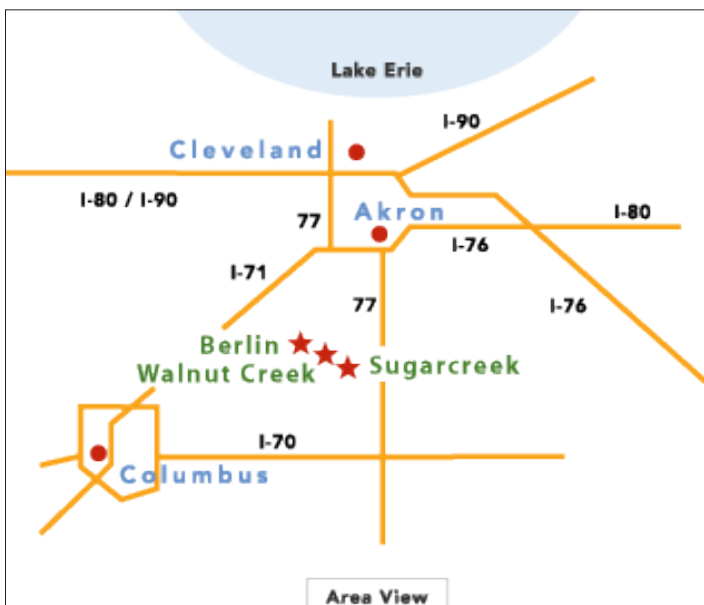

Room Descriptions

Carlisle Inn Walnut Creek features 52 guest rooms with beautiful views of the surrounding countryside. Nearly all rooms have access to a balcony or porch. Each guest room is tastefully decorated with country charm. First floor guest rooms feature Oak woodwork and furniture, while the top two floors feature Cherry—all by local Amish craftsman.

Room Count

- 28 standard rooms with two queen beds
- 8 smaller standard rooms with one queen bed
- 5 standard rooms with one king bed and sleeper sofa
- 6 executive rooms with one king bed and sleeper sofa
- 2 two-bedroom suites with two queen beds and sleeper sofa
- 2 honeymoon suites with one king bed and sleeper sofa
- 1 handicapped accessible with one queen bed and one twin bed

Note: Carlisle Inn is a smoke-free facility, this includes all porches and balconies. Alcoholic beverages are not served or permitted in our meeting rooms and public areas. Sorry, we do not allow pets in our hotels.

Standard Room –

Choice of one queen bed, two queen beds, or one king and sleeper sofa

Amenities include:

Balcony or porch
 Separate dressing area with sink
except for single queen rooms
 Television
 Small dining table with 2 chairs
 Upholstered furniture
except for single queen rooms
 Small refrigerator
 Coffee maker
 Hair dryer
 Iron with ironing board

Executive Room –

Large corner bedroom with one king bed and sitting area

Amenities include:

Balcony or porch
except for third-floor executive rooms
 Walk-in Shower
 Television
 Two Recliners
 Small dining table with two chairs
 Small refrigerator
 Microwave
 Sink in microwave area
 Coffee maker
 Hair dryer
 Iron & ironing board

Two-Bedroom Suite –

Each bedroom has one queen bed and bathroom

Bedroom amenities include:

Television
 Hair-dryer

Common area amenities include:

Covered porch
 Television
 Small dining table with four chairs
 Sleeper sofa
 Upholstered chairs
 Refrigerator
 Microwave
 Coffee maker
 Sink in microwave area
 Iron with ironing board

Honeymoon Suite –

Bedroom with one king bed and adjoining sitting room

Amenities include:

Covered porch
 Large bathroom with jacuzzi (2 person)
 Walk-in Shower
 Television
 Sleeper sofa
 Two upholstered chairs
 Small dining table with two chairs
 Small refrigerator
 Microwave
 Sink in microwave area
 Coffee maker
 Hair dryer
 Iron & ironing board



Group Reservation Guidelines

Rates & Payment –

Group rates require a minimum purchase of 10 guest rooms.

Payment must be made by *one* check or credit card.

Rates are based on two guests for Standard Rooms and Executive Rooms and four guests for Two-Bedroom Suites. Additional charge of \$10.00 per adult will be added if more than two guests share a room.

Deposit –

1. A signed contract due within 14 days after contract is received.
2. A \$50.00 per room per night deposit is due 45 days prior to arrival.

Rooming List –

A detailed rooming list must be submitted no later than two weeks prior to the reservation date. Regular guest room rates will apply if final rooming list is less than 10 rooms.

Cancellation & Refund –

For a group cancellation received 45 days or more prior to the reservation date, 100% of the deposit is refunded.

If any rooms in a group reservation are canceled 44 days or less prior to the reservation date, we will make every effort to re-book the cancellation rooms. In the event the rooms remain unsold, the normal room rate in effect at the time of the reservation will be charged to your account.

Discount –

Any group purchasing 10 or more rooms will receive one complimentary room.

Smoke and Alcohol-free Policy –

The Carlisle Inns are smoke free facilities. Per Ohio Code, smoking is permitted outside, but must be 30 feet away from the building. A group will be charged a cleaning fee for each room in which a group participant has smoked, this includes balconies and porches. Alcoholic beverages are not served or permitted in our meeting rooms and public areas.



Peace & Comfort
WALNUT CREEK

4949 Walnut Street, SR515
Walnut Creek, Ohio 44687
Phone 330 893 3636
1-855-400-2275

www.dhgroup.com

INN HOURS
Open all year
Noon Closing - Christmas Eve Day
Closed Christmas Day

Our mailing address is:
Carlisle Inn
P.O. Box 177
Walnut Creek, Ohio 44687

Meeting Rooms & Rentals

Carlisle Inn offers excellent facilities for groups in the peaceful and scenic setting of Walnut Creek, Ohio. In our lower level banquet facility, we can accommodate groups up to 475 and offer plenty of parking and no-step entrances for easy access. Our third floor Board Room accommodates up to 60 people in theater-style seating. The entire inn has wireless Internet access.

Room Floor Plans

Both our Board Room and lower level conference rooms are versatile spaces.

Chairs and tables may be arranged to suit your needs and rentals are available for one or multiple rooms. Please refer to the following page for pricing and room configurations.

Please specify your desired room arrangement when booking your event.

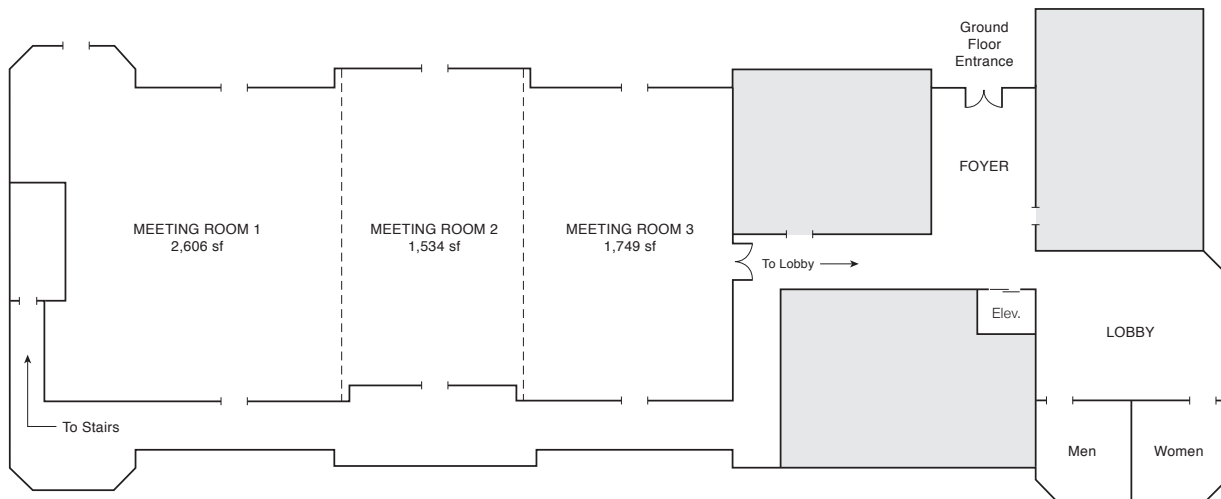
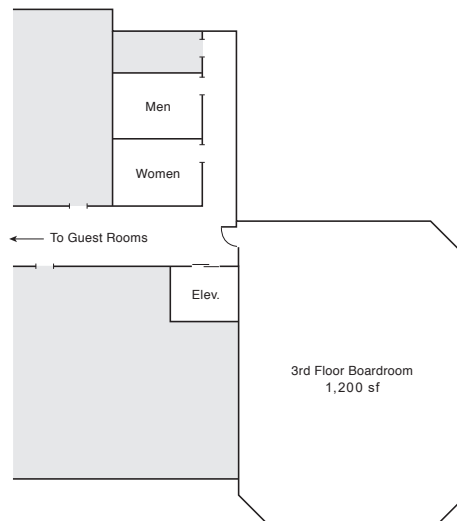

Seating Capacity

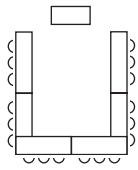
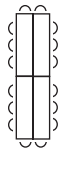
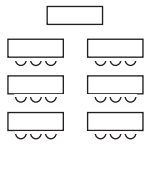
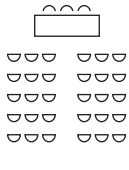
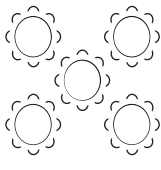
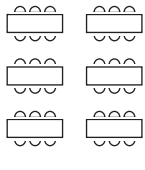
Room Configurations	 U-formation	 Conference	 Classroom-style	 Theater-style	 Round Tables	 Banquet-style
	U-formation	Conference	Classroom-style	Theater-style	Round Tables	Banquet-style
Board Room	35	20	40	60	–	–
Room 1	48	–	70	–	64	–
Room 2	48	–	70	–	64	–
Room 3	90	–	110	–	80	–
All 3 Rooms	–	–	175	–	200	–

Pricing & Terms

Terms

If you have a meeting with a meal, there is no room charge—unless the meal and meeting time exceed 3 hours. After 3 hours, a half-day room charge will apply. For half-day rates, the rental period begins and/or ends at 1pm.

Prices subject to change without notice.

Lower Level Conference Rooms

The lower level meeting rooms (1,2 and 3) are equipped with sound and AV equipment. Rental unlimited coffee and water service 2.99 per person.

Room 1 –

Monday through Thursday
Full Day \$600, Half day \$300

Fridays and Saturdays
Full Day \$1000, Half Day \$500

Room 2 –

Monday through Friday
Full Day \$275, Half day \$175

Saturdays
Full Day \$450, Half Day \$350

Room 3 –

Monday through Friday
Full Day \$350, Half day \$250

Saturdays
Full Day \$550, Half Day \$450

All 3 rooms –

Monday through Thursday
Full Day \$1800, Half day \$900

Fridays and Saturdays
Full Day \$3000, Half Day \$1500

Additional items –

- Tablecloths \$4.50 *each*
- Napkins \$0.50 *each*
- Round Tables \$10.00 *each*
Seats 8 per table
- Punch Fountain \$30.00
- Stage—16' x 8' \$60.00
- 90" TV Screen \$25.00
3 available
- Backdrop Curtain \$35.00
- Luminara Candle Centerpiece
with greenery \$5.00 *each*

Seasonal Discount –

During January, February, and March, we offer a 10% discount for a one-day meeting in our conference rooms with a group meal and a 20% discount for a two-day meeting with a group meal.

Third Floor Board Room –

We do not offer dining in this room.

Carlisle Inn offers a discount off the board room rate to groups renting 10 or more guest rooms.

Full Day \$250, Half Day \$150

Rental of board room includes:

- Unlimited coffee, hot tea, and water service
- White linens on straight tables
- Pen and paper for each attendee
- Wrapped candies on tables
- Podium
- Screen
- Built-in stereo sound
- High quality AV equipment
- Flat screen TV/ DVD
- Flip chart
- Wifi access

Prior to meeting each morning and during scheduled breaks the room will be refreshed.